

GAGE SIZE	STANDARD STYLE 1			RIGHT ANGLE STYLE 2				VERTICAL STYLE 3			PERPENDICULAR STYLE 4			PISTOL GRIP STYLE 5			FLUSH STYLE 7
	A		B	A		B	C	A		B	A		B	A		B	B
	STD	MIN		STD	MIN			STD	MIN		STD	MIN		STD	MIN		
2	5.00"	2.31"	8.12"	2.53"	2.35"	3.88"	6.25"	6.00"	2.31"	8.75"	6.00"	2.31"	8.13"	1.63"	1.63"	5.75"	-
3	5.00"	2.63"	10.50"	2.53"	2.35"	3.88"	6.25"	6.00"	2.63"	9.00"	6.00"	2.63"	8.13"	1.63"	1.63"	5.75"	-
4	5.00"	2.63"	10.50"	2.53"	2.35"	3.88"	6.25"	6.00"	2.63"	9.00"	6.00"	2.63"	8.13"	1.63"	1.63"	5.75"	-
5	6.00"	2.63"	11.50"	2.53"	2.35"	3.83"	6.25"	6.00"	2.63"	9.00"	6.00"	2.63"	8.13"	1.63"	1.63"	5.75"	-
6	6.00"	2.63"	12.00"	2.50"	2.50"	4.44"	6.69"	6.00"	5.50"	9.44"	6.00"	4.00"	8.13"	3.00"	3.00"	9.38"	1.50"

D = Standard gaging range
 E = Gaging range with optional offset contacts
 F = Maximum gaging range with extension adapters
 G = Standard center line
 H = Offset center line modification add -H to part #
 J = Standard gaging plunger travel
 K = Optional extended plunger travel add -K to part #

GAGE-HEAD DIMENSIONS (ALL STYLES)

SIZE	D		E		F	G	H	J	K	RANGE EXTENSION ADAPTER PART #
	MIN	MAX	MIN	MAX						
2	1.00"	1.53"	1.19"	1.69"	1.75"	.195"	.140"	.025"	.050"	DS-B0-85929
3	1.50"	2.16"	1.69"	2.56"	3.13"	.224"	.156"	.025"	.050"	DS-B0-85934
4	2.12"	3.13"	2.56"	3.56"	4.00"	.224"	.032"	.025"	.075"	DS-B0-85942
5	3.09"	6.13"	3.50"	6.44"	8.00"	.224"	.032"	.025"	.075"	DS-B0-85952
6	6.00"	12.13"	6.44"	12.63"	24.00"	.312"	.032"	.030"	.100"	DS-B0-85966

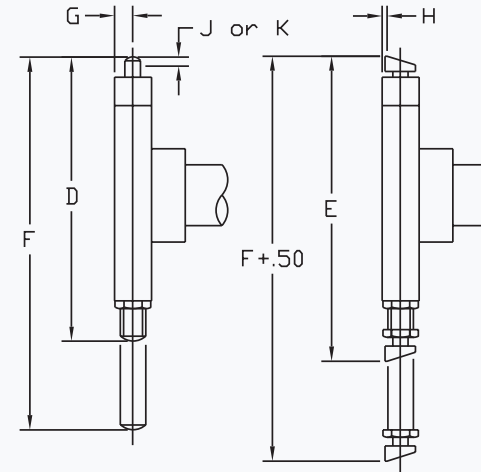

BORE GAGE EXTENSION HOUSING #3, 4 & 5

EXTENSION HOUSING ASSEMBLY	
PART #	DESCRIPTION
DX2-8100503	3" "A" LENGTH EXTENSION
DX2-8100504	4" "A" LENGTH EXTENSION
DX2-8100505	5" "A" LENGTH EXTENSION
DX2-8100506	6" "A" LENGTH EXTENSION
DX2-8100508	8" "A" LENGTH EXTENSION
DX2-8100510	10" "A" LENGTH EXTENSION
DX2-8100512	12" "A" LENGTH EXTENSION
DX2-8100514	14" "A" LENGTH EXTENSION
DX2-8100516	16" "A" LENGTH EXTENSION
DX2-8100518	18" "A" LENGTH EXTENSION
DX2-8100524	24" "A" LENGTH EXTENSION
DX2-8100530	30" "A" LENGTH EXTENSION
DX2-8100536	36" "A" LENGTH EXTENSION
Other Lengths Available	
37-71"	
72-144"	

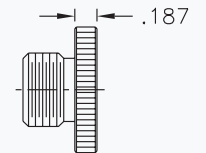

BORE GAGE DUST CAP

- ✓ Replaces standard handle.
- ✓ Minimize overall length ("B" dimension).

SIZE	REDUCES "B" DIM. BY	PART #
2-6	2.06"	DS-B0-84725
6 Heavy Duty	2.81"	DS-B0-84731